

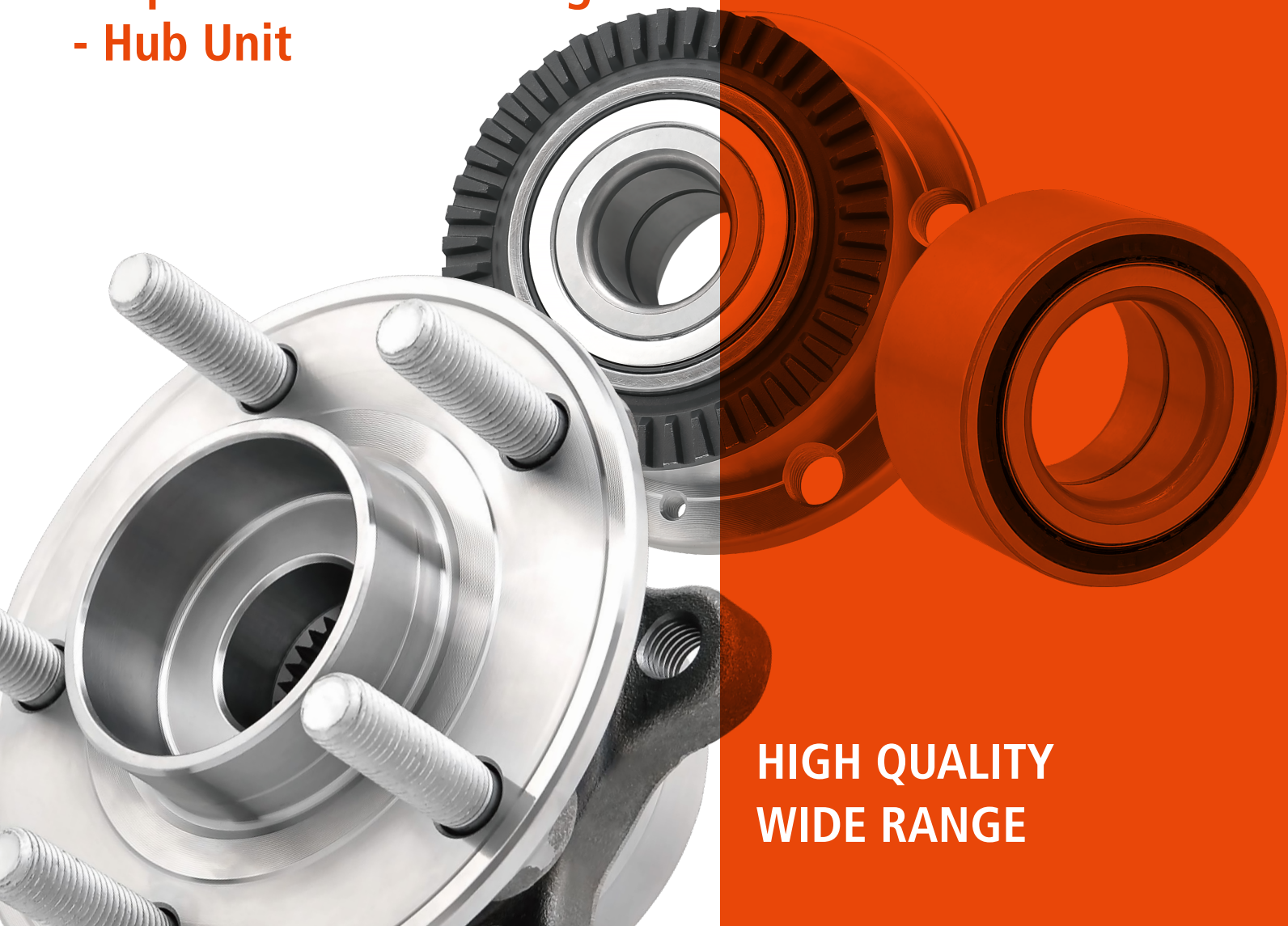

## WHEEL HUB ASSEMBLY

- Ball Bearing
- Tapered Roller Bearing
- Hub Unit



HIGH QUALITY  
WIDE RANGE



## WHEEL HUB ASSEMBLY

### PHC, Korea No.1 Aftermarket Auto Part Brand

PHC aftermarket has succeeded in supplying high-performance wheel hub bearing with advanced technology and is continuing its reputation as a global aftermarket auto parts distributor by supplying cutting-edge products.

PHC Wheel Hub Bearing provides driving safety and comfort by smooth bearing operation with strict production management, proper material selection and rigorous quality control system.

PHC is supplying over 950 parts to meet market demand with high quality wheel bearing

**\*Products include: Ball bearing / Tapered roller bearing**



1st generation



2nd generation



3rd generation



## High Quality Wide Range



**Number of parts : Over 950**

**Certificate : IATF16949 / ISO14001**

# FEATURES OF 1st Generation



## Benefits / TYPES

PHC wheel bearings are comprised of two or more sets of angular contact ball bearings or tapered roller bearings

- Featuring good assembly performance
- Adjustment free built in clearance
- Light weight
- Compact structure
- Large carrying capacity
- The interior is filed with high performance grease, integrated high performance seals saving exterior seals, thus maintenance free.
- Widely used in cars and trucks.

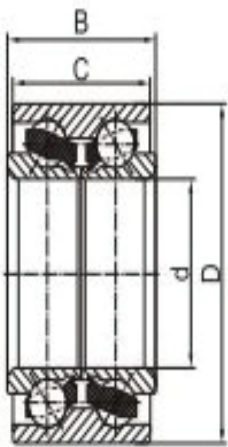

Ball bearing

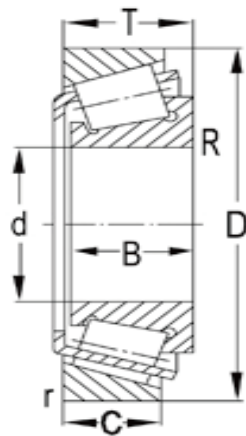

Tapered Single  
Roller Bearing

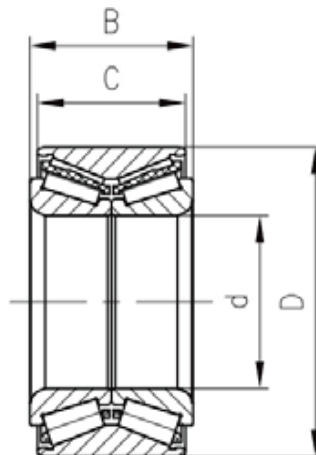

Tapered Double  
Roller Bearing

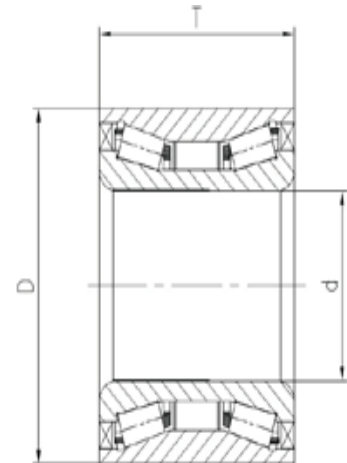

Truck Roller Bearing

# Product Search

## Guidelines : Ball bearing

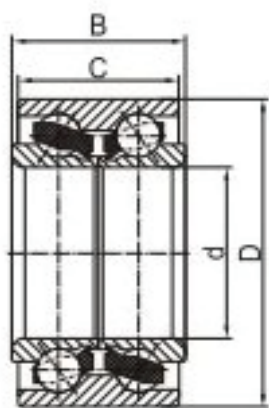

A type



B type



C type



D type



E type



F type



Dimension(mm)											
d	D	B	C	rx(min.)	ry(min.)	Seal Type	Ball×Num	Load Ratings(KN)		Weight	Magnetic Num
								Cr	Cor		
20.0	42.0	30.0	29.0	0.7	0.7	C	6.35×30	-	-	0.23	-
25.0	52.0	20.6	20.6	0.5	0.5	-	-	-	-	0.19	-
25.0	52.0	37.0	37.0	2.3	1.5	B C D	8.731×24	28.0	21.0	0.31	-
25.0	52.0	40.0	40.0	2.3	1.5	C	8.731×24	28.0	21.0	0.35	-
25.0	52.0	42.0	42.0	2.3	1.5	A C E	8.731×24	28.0	21.0	0.36	-
25.0	52.0	43.0	43.0	2.3	1.5	C D	8.731×24	28.0	21.0	0.36	-

# Product Search

## Guidelines : Tapered Single Roller Bearing

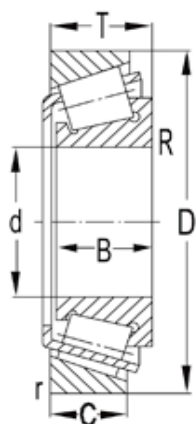
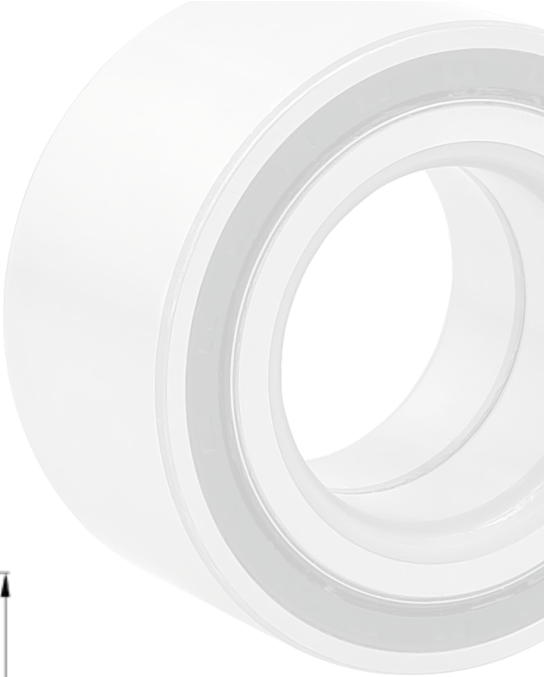

By METRIC

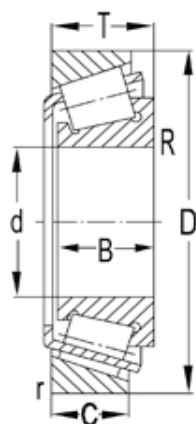

By INCH



Dimensions(mm)							Weight	Load Ratings(KN)	
d	D	T	B	C	Rmin	rmin		Cr	Cor
17	40	13.25	12	11	1	1	0.079	20.8	21.8
17	47	15.25	14	12	1	1	0.129	28.2	27.2
17	47	20.25	19	16	1	1	0.173	35.3	36.3
20	42	15	15	12	0.6	0.6	0.097	25.1	28.2
20	47	15.25	14	12	1	1	0.12	28.2	30.6
20	47	19.25	18	15	1	1	0.161	35.5	37.5



# Product Search

## Guidelines : Tapered Double Roller Bearing

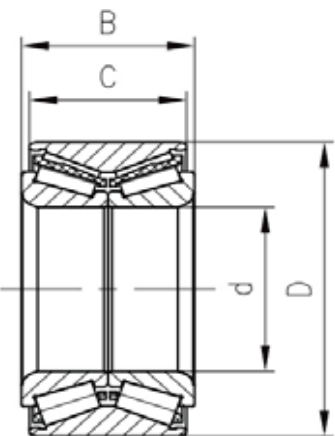
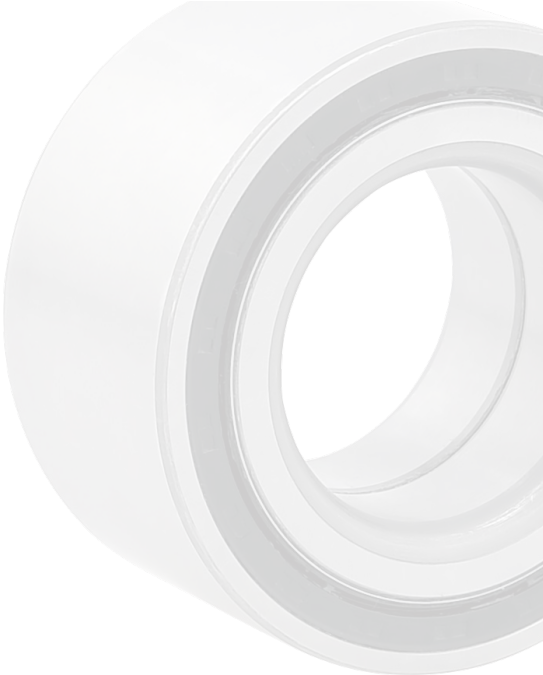

A type



B type



C type



D type

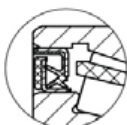

E type

Dimensions(mm)				Seal Type	Roller Size	Weight
d	D	B	C			
25	52	37	37	B D	$\Phi 6.808 \times 10.84 \times 2^\circ$	0.36
25	52	43	43	A	$\Phi 6.808 \times 10.84 \times 2^\circ$	0.384
25	55	43	43	A	$\Phi 6.808 \times 10.84 \times 2^\circ$	0.498
25	55	45	45	A	$\Phi 6.808 \times 10.84 \times 2^\circ$	0.522
25	62	48	48	A	$\Phi 8.195 \times 14.48 \times 2^\circ$	0.55
27	52	45	43	C	$\Phi 6.799 \times 10.8 \times 2^\circ$	0.396

# Product Search

## Guidelines : Tapered Roller Bearing for Truck

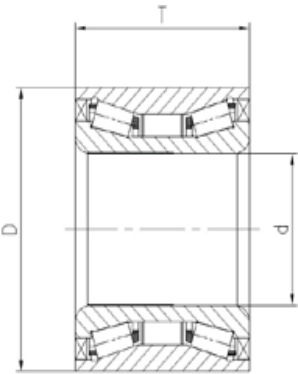

**Series : A**

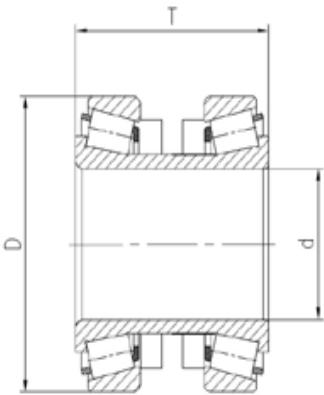

**Series : B**

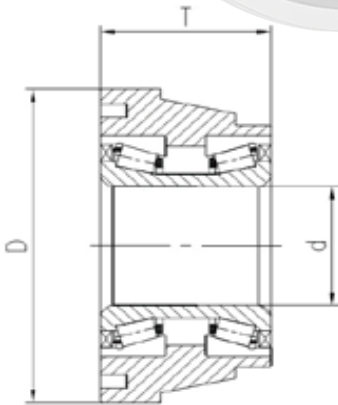

**Series : C**

Dimensions(mm)			Series	Weight
d	D	T		
68.000/68.200	127.000 / 132.000	115.000	A	6.50
82.000	140.000	115.000	A	6.45
60.000	108.000	75.000	A	2.83
55.000	90.000	60.000	A	1.40
90.000	160.000	160.000	A	10.24

# FEATURES OF 2nd - 3rd Generation



## Benefits

---

Having all the characteristics of the first generation wheel bearings, the 2nd & 3rd generation products can be bolted directly to suspension or installed on brakes and wheels.

with integrated mounting flange in outer or inner ring for 2nd & 3rd generation products.

- Simpler structure
- Fewer parts
- Lighter weight
- Easy installation
- In the meantime more compact structure & light weight thanks to integrated ABS sensor components available for the majority of products.
- Widely used in cars and SUV cars.



# PRODUCTION PERFORMANCE TECHNOLOGY

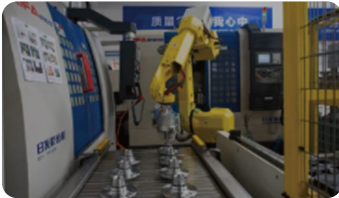
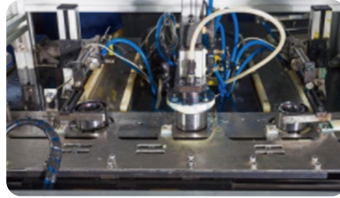

## High end technology and automated production lines

PHC Wheel bearing are manufactured by over 400 leading processing equipment with digital control technology to facilitate full process control, a solid hardware guarantee for us to offer products that truly satisfy our customers.

## Full spectrum quality inspection facilities

All kinds of high precision testing instruments are worked for the production field directly. It will control the whole production process in time and promise the size, shape, performance consistency and stability.

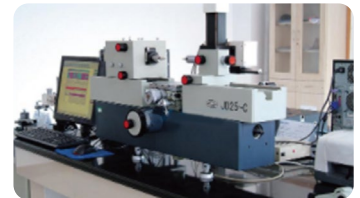
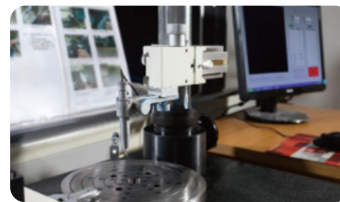

# TESTING QUALITY ASSURANCE SERVICE



## Packaging

### Packaging Protective & Solid Applicable to all sizes of Wheel bearing

PHC wheel bearing is packed in a plastic cover, packaging box, and solid cardboard box. These three layers of protection prevent any damages during transportation. Also, the improved packaging is suitable for covering all sizes of wheel bearing.

## Quality Assurance

### Highly ensured product reliability and quality

With an extensive and stringent quality control system, PHC products are free from any types of defects in materials and workmanship. Also, PHC is striving for customer satisfaction and ready for customer requests.

## Customer Service

### Delivery

PHC is always punctual on delivery dates and accurate in delivering the right items. Controlling over 40 product lines proves a highly organized logistics system. Find more items via our web page, 'www.koreavaleo.com'.

### Quotation & Find the right parts

We are always ready for a quick response. Please visit the PHC web page or web catalog for more information.

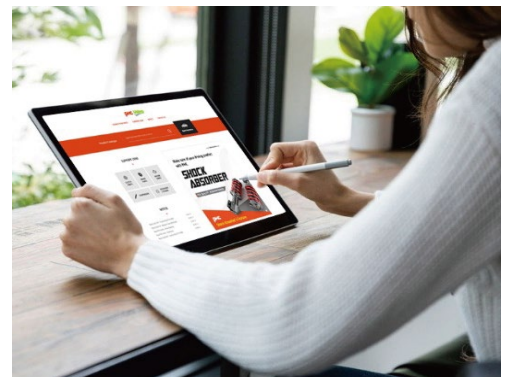



**Contact us**

Tel. +82-2-734-3711 / +82-54-930-0543

E-mail. [marketing-vphi@vph.com](mailto:marketing-vphi@vph.com)

**Website**

Web page: [www.koreavaleo.com](http://www.koreavaleo.com)

Web catalog: [www.phcvaleo-webcat.com](http://www.phcvaleo-webcat.com)



Find the right spare parts on web-catalog

**Valeo Pyeong Hwa International Co.,Ltd.**